

Installation Instructions for the AU56 Par56 replacement L.E.D. light.



Installation Instructions:

Before starting any work on your pool or spa lights ensure that all electrical power is disconnected from the pool light.

1. Remove the existing underwater light from the niche/bucket and raise it above the water level.
2. It is extremely important to ensure that no water enters the light when dismantling the light body.
Dismantle the light body and disconnect the Par56 lamp and check the condition of the o'ring (it is always recommended that the o'ring be replaced with a new one).
3. Connect the AU56 L.E.D. unit in exactly the same way as the Par56 was connected, ensuring clean, tight connections at the terminal posts.
4. Re-assemble the light and install back into the niche/bucket in the reverse order to which it was removed.

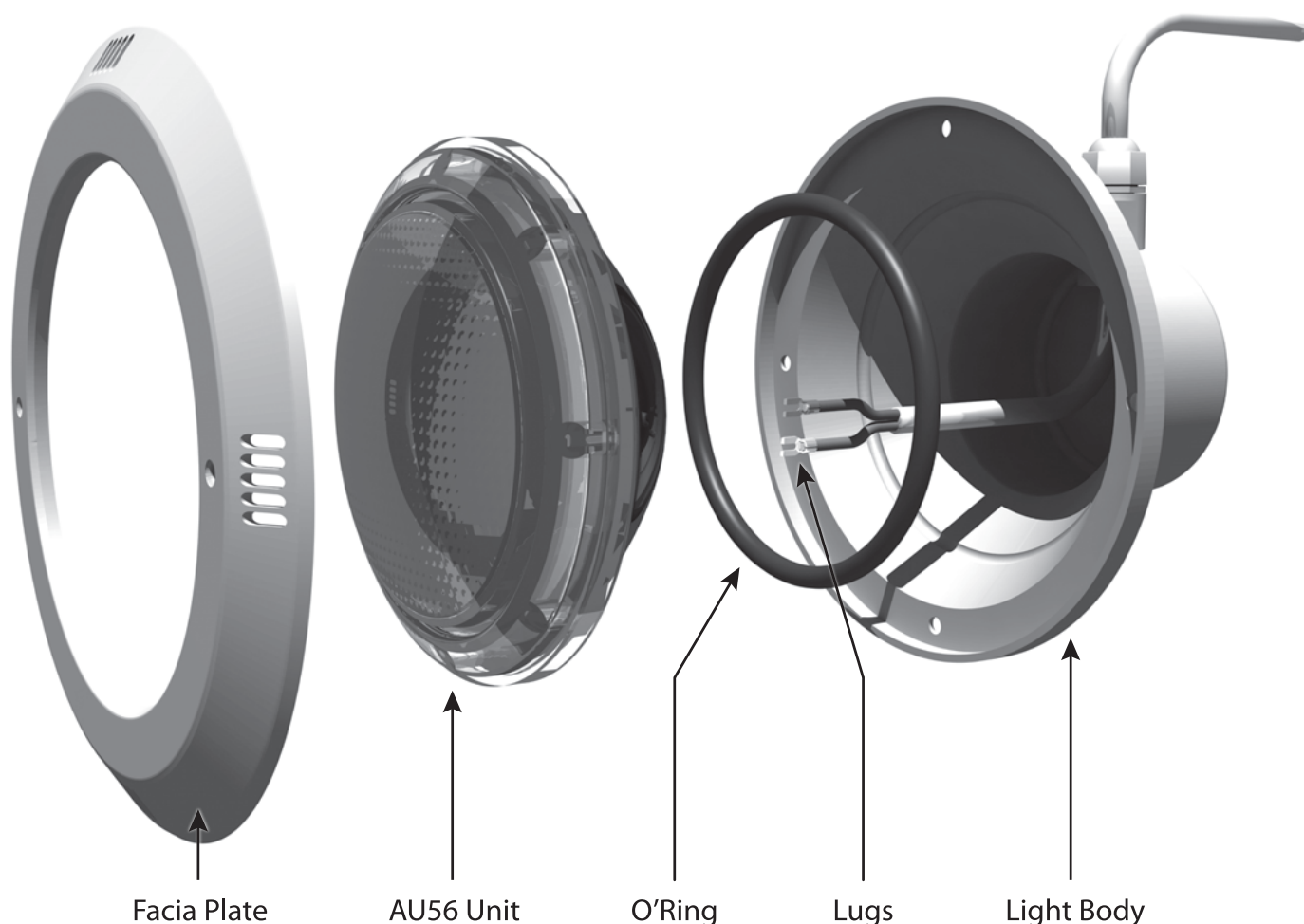

Important Notes:

- Refer to light manufacturers instructions regarding the dismantling of your light.
- Inspect the light body for any cracks or possible damage, if present, spare parts may be required, please refer to the light manufacturers instructions.
- Ensure no water/moisture enters the body of the light.
- All seals or o'rings should be replaced with new parts to ensure the best possible seal.
- 12VAC only.
- Note that only the AU56 lamp unit is supplied, for any seals or other components please contact your particular lights manufacturer.

Spa Electrics PTY LTD accepts no responsibility for product failure due to poor sealing, defective housings or poor installation practices.



Rainbow Pool Products
PO Box 2388, Mansfield Qld 4122

Telephone STD 61-7-3849 5385

Facsimile STD 61-7-3849 5384

Email: info@rainbowpoolproducts.com.au Web: www.rainbowpoolproducts.com.au